

## INS-R-700 & INS-R-750

### STEP 1: INSTALL NEW NOZZLE

- Remove screws (2) on top of nozzle cap.
- Pull off nozzle cap.
- Snap in correct nozzle.  
(see Performance Chart).
- To remove nozzle, pull out using snap ring tool or screwdriver
- While compressing spring and grasping riser, re-install nozzle cap with screws (2).\*
- Release spring to create riser assembly as shown.

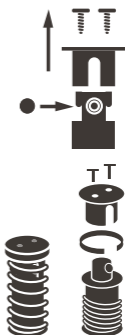

### STEP 2: ADJUSTABLE PART CIRCLE OPTION

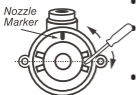

- Rotate EASY ARC TABS to desired arc.
- Using a small screw driver or pointed object, move right and left tabs on each side of the Nozzle Marker. Example 180°
- Install EASY ARC cap.

**NOTE: For part circle operation, make sure nozzle faces area to be irrigated.**

### STEP 3: INSTALL RISER ASSEMBLY

- Place riser assembly in body.
- Squeeze snap ring slightly and give assembly a quick downward tap to lock in place.



## PERFORMANCE DATA

**INS-R-700 & INS-R-750**

Nozzle	Pressure	Radius*	Discharge	Pressure	Max. Radius*	Discharge
	PSI	ft.	gpm	BAR	m	L/s
<b>16 Orange</b>	50	52	12.5	3.4	15.8	0.78
	60	55	13.5	4.1	16.7	0.85
	70	57	15	4.8	17.3	0.94
	80	61	17	5.5	18.5	1.16
	90	61	18	6.2	18.5	1.16
	100	61	19	6.9	18.5	1.16
<b>21 Brown</b>	50	55	17	3.4	16.7	1.05
	60	58	18.5	4.1	17.6	1.11
	70	60	20	4.8	18.2	1.14
	80	62	22	5.5	18.9	1.19
	90	62	23.5	6.2	18.9	1.19
	100	62	24	6.9	18.9	1.19
<b>26 Blue</b>	50	60	22	3.4	18.2	1.38
	60	62	23.5	4.1	18.9	1.48
	70	65	25	4.8	19.8	1.57
	80	66	26	5.5	20.1	1.64
	90	67	27	6.2	20.4	1.7
	100	67	28.5	6.9	20.4	1.79
<b>29 Red</b>	50	64	24.5	3.4	19.5	1.54
	60	66	26	4.1	20.1	1.64
	70	67	27.5	4.8	20.4	1.73
	80	68	29	5.5	20.7	1.82
	90	70	31.5	6.2	21.3	1.98
	100	70	33	6.9	21.3	2.08



Customer Service

405-938-5533 | [customerservice@bearirrigation.com](mailto:customerservice@bearirrigation.com)

99903381\_rev1000