

INSTALLATION AND PART CIRCLE ADJUSTMENT GUIDE

INS-T-650-680-780-X

REPLACES: TORO® 650, 680, 750, 780

STEP 1: INSTALL NEW NOZZLE

- Remove screws (2) on top of nozzle cap.
- Pull off nozzle cap.
- Snap in correct nozzle. (see Performance Chart).
- To remove nozzle, pull out using snap ring tool or screwdriver.

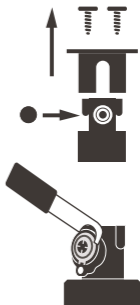

STEP 2: ADJUSTABLE PART CIRCLE OPERATION

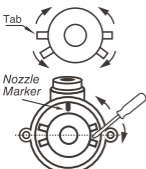

- Rotate EASY ARC TABS to desired arc.
- Using a small screw driver or pointed object, move right and left tabs on each side of the Nozzle Marker. Example 180°
- Install EASY ARC cap.

STEP 3: INSTALL NEW CONVERSION DRIVE ASSEMBLY

- Place new assembly in body.
- Install new snap ring.
- Reinstall cap with screws (2).

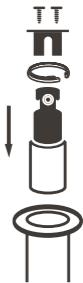

IMPORTANT: Tighten screws securely.

PERFORMANCE DATA

INS-T-650-680-780-X

Nozzle	Pressure	Radius*	Discharge	Pressure	Max. Radius*	Discharge	Toro Nozzle Reference	
	PSI	ft.	gpm	BAR	m	L/s	650	780
16 Orange	50	56	13	3.4	17	0.82	54	83
	60	57	14.2	4.1	17.3	0.89		
	70	58	15.4	4.8	17.6	0.97		
	80	59	16.4	5.5	17.9	1.03		
	90	60	17.5	6.2	18.2	1.1		
	100	61	18.6	6.9	18.5	1.17		
21 Brown	50	61	16.4	3.4	18.5	1.03	55	84
	60	62	18	4.1	18.8	1.13		
	70	64	19.4	4.8	19.5	1.22		
	80	65	20.7	5.5	19.8	1.30		
	90	68	21.9	6.2	20.7	1.38		
	100	70	23.1	6.9	21.3	1.45		
26 Blue	50	62	21.8	3.4	18.8	1.37	56	85
	60	64	23.4	4.1	19.5	1.47		
	70	66	24.8	4.8	20.1	1.56		
	80	67	26	5.5	20.4	1.64		
	90	70	28.1	6.2	21.3	1.77		
	100	70	28.1	6.9	21.3	1.77		
29 Red	50	65	22.4	3.4	19.8	1.41	57	
	60	70	25.2	4.1	21.3	1.58		
	70	72	27	4.8	21.9	1.7		
	80	75	28.8	5.5	22.8	1.81		
	90	77	30.6	6.2	23.4	1.93		
	100	79	32.1	6.9	24	2.02		
32 Gray	50	66	25.8	3.4	20.1	1.62	58	86
	60	71	26.9	4.1	21.6	1.69		
	70	75	29.7	4.8	22.8	1.87		
	80	78	31.7	5.5	23.7	1.99		
	90	80	33.5	6.2	24.3	2.11		
	100	82	35.3	6.9	24.9	2.22		